



www.avishop.com  
 Tel:832-831-6180  
 Support:customerservice@avishop.com

**USER MANUAL**

**HDBaseT Wallplate Transceiver**

**HDBaseT Wallplate Transceiver**

Supports 3D, 4Kx2K@60Hz(YUV 4:2:0) HDCP



**Notice**

The information in this document is subject to change without notice. Every effort has been made in the preparation of this document to ensure accuracy of the contents, but all statements, information, and recommendations in this document do not constitute the warranty of any kind, express or implied.

**Features**

- Extend 1080p up to 230ft and 4K up to 115ft Over One Cat 6 Cable
- Supports resolution Ultra HD 4Kx2K(3840x2160@60Hz YUV 4:2:0) 1080p & 3D
- HDBaseT Compliant
- HDCP Compliant
- POC (Power Over Cable)
- Status LED for All Connections on Front
- Wall Mountable Single Gang Wall Plate Form Factor

**Package Contents**

- 1 x Wallplate Transmitter
- 1 x Wallplate Receiver
- 1 x 24V/1A DC Adapter

**SPECIFICATIONS**

Operating Temperature Range	-5 to +35°C (+23 to +95°F)
Operating Humidity Range	5 to 90%RH (No Condensation)
Bandwidth frequency	10.2Gbps
Input ports	1xHDMI(female)
Output ports	1xRJ outputs(female)
Resolution outputs	up to 4Kx2K(3840x2160@60Hz YUV 4:2:0)
Dimensions(LxWxH)	114x70x24.6mm
Power consumption	1W(MAX)
Transmission Distance	1080p up to 230ft;4k up to 115ft over cat6 cable
Net Weight	300g

**TX PANEL DESCRIPTIONS**

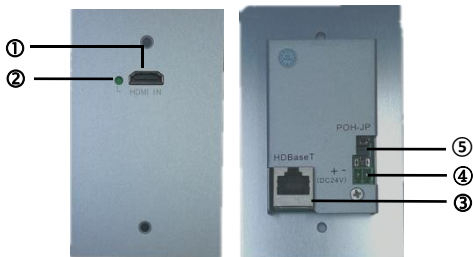

- ① HDMI input ports
- ② Indicator of HDBaseT Link
- ③ HDBaseT Output port
- ④ Power input
- ⑤ POC Jumper: transfer power on cat cable when closed, power removed when open

**RX PANEL DESCRIPTIONS**

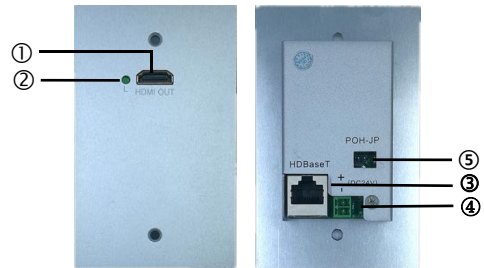

- ① HDMI output ports
- ② Indicator of HDBaseT Link
- ③ HDBaseT Input port
- ④ Power input
- ⑤ POC Jumper: transfer power on cat cable when closed, power removed when open

**Connecting and operating**

- 1) Connect the wall plate transmitter and receiver by Cat Cable.
- 2) Connect the power adaptor either on transmitter or receiver and power up .
- 3) Power up the source and display.
- 4) Connect the transmitter to HDMI source and receiver to display.



**Safety information**

Safeguards



**To reduce the risk of electric shock, do not expose this product to rain or moisture**

**PRODUCT SERVICE**

- 1) Damage requiring service:** The unit should be serviced by qualified service personnel if:
  - (a) The DC power supply cord or AC adaptor has been damaged;
  - (b) Objects or liquids have gotten into the unit;
  - (c) The unit has been exposed to rain;
  - (d) The unit does not operate normally or exhibits a marked change in performance;
  - (e) The unit has been dropped or the cabinet damaged.
- 2) Replacement parts:** When parts need replacing ensure the servicer uses parts specified by the manufacturer or parts that have the same characteristics as the original parts. Unauthorized substitutes may result in fire, electric shock, or other hazards.
- 3) Safety check:** After repairs or service, ask the servicer to perform safety checks to confirm that the unit is in proper working condition.

**WARRANTY**

If your product does not work properly because of a defect in materials or workmanship, our Company (referred to as "the warrantor" ) will , for the length of the period indicated as below, **(Parts(2)Years ,Labor(90) Days)** which starts with the date of original purchase ("Limited Warranty period"), at its option either (a) repair your product with new or refurbished parts, or (b) replace it with a new of a refurbished product. The decision to repair or replace will be made by the warrantor. During the "Labor" Limited Warranty period there will be no charge for labor. During the "Parts" warranty period, there will be no charge for parts. You must mail-in your product during the warranty period. This Limited Warranty is extended only to the original purchaser and only covers product purchased as new. A purchase receipt or other proof of original purchase date is required for Limited Warranty service.

**Mail-In Service**

When shipping the unit carefully pack and send it prepaid, adequately insured and preferably in the original carton. Include a letter detailing the complaint and provide a day time phone and/or email address where you can be reached.

**LIMITED WARRANTY LIMITS AND EXCLUSIONS**

- 1) This Limited Warranty ONLY COVERS failures due to defects in materials or workmanship, and DOES NOT COVER normal wear and tear or cosmetic damage. The Limited Warranty ALSO DOES NOT COVER damages which occurred in shipment, or failures which are caused by products not supplied by warrantor, or failures which result from accidents, misuse, abuse, neglect, mishandling, misapplication, alteration, faulty installation, set-up adjustments, misadjustment of consumer controls, improper maintenance, power line surge, lightning damage, modification, or service by anyone other than a Factory Service center or other Authorized Servicer, or damage that is attributable to acts of God.
- 2) THERE ARE NO EXPRESS WARRANTIES EXCEPT AS LISTED UNDER "LIMITED WARRANTY COVERAGE". THE WARRANTOR IS NOT LIABLE FOR INCIDENTAL OR CONSEQUENTIAL DAMAGES RESULTING FROM THE USE OF THIS PRODUCT, OR ARISING OUT OF ANY BREACH OF THIS WARRANTY. (As examples, this excludes damages for lost time, cost of having someone remove or re-install an installed unit if applicable, travel to and from the service, loss of or damage to media or images, data or other recorded content. The items listed are not exclusive, but are for illustration only.
- 3) PARTS AND SERVICE, WHICH ARE NOT COVERED BY THIS LIMITED WARRANTY, ARE YOUR RESPONSIBILITY.



AV Integration, Inc  
 www.avishop.com  
 Tel:832-831-6180

Support:customerservice@avishop.com  
 Address: 9950 Westpark Dr 126 Houston TX 77063 USA